

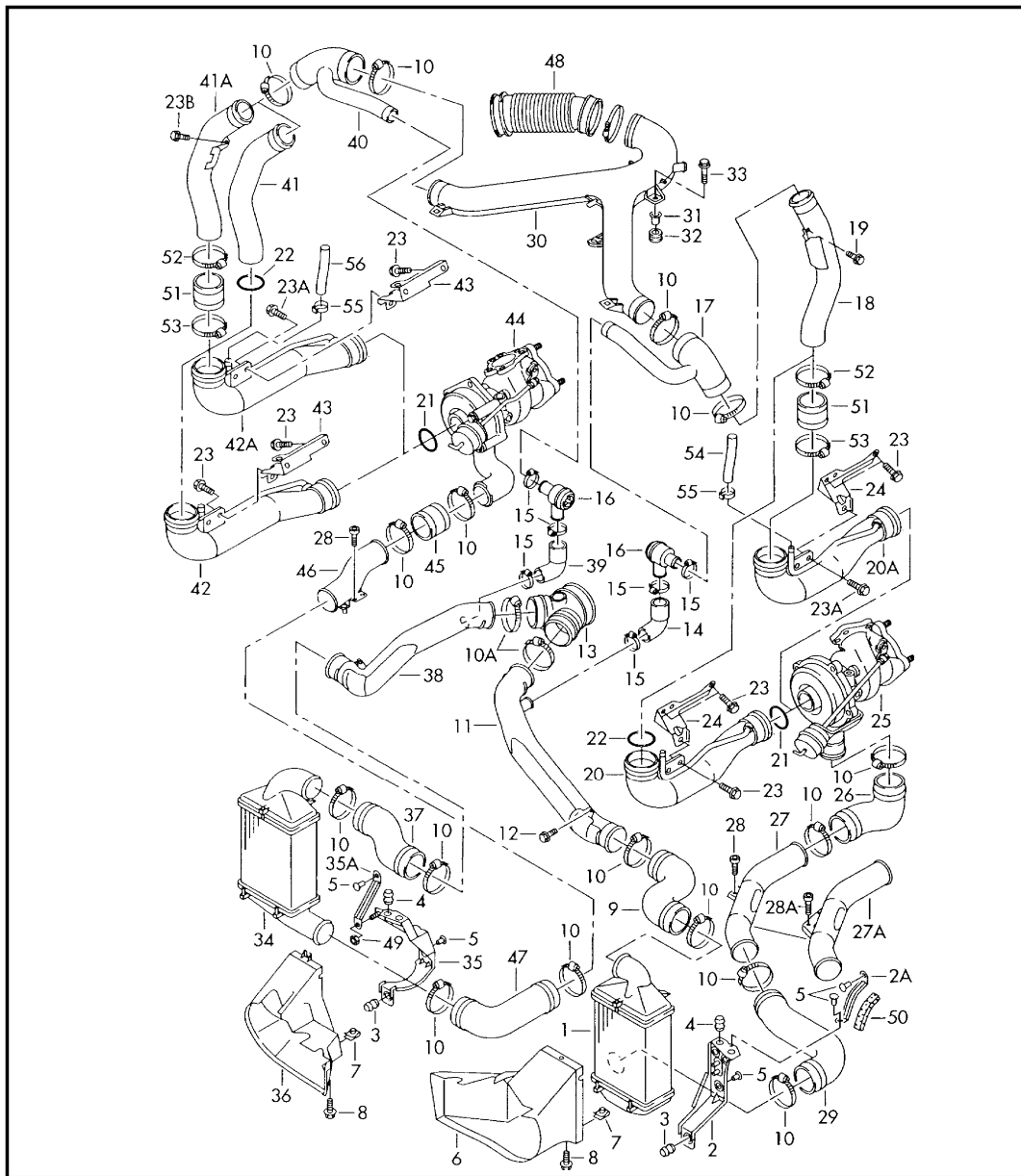

Model	Year	MG	SG	Illustration	Restrictions	UPD	15:31	19.03.2009		ETKA
A4Q	2002	1	45	145-95	>> 8D-2-010 000	713	USA			



Pos	Part Number	Name	Remarks	Qty	Model
		charge air cooler	2,7ltr.	1	6 cylinder: APB
(1)	078 145 805 N	charge air cooler F 8D-1-109 081>>*	left	1	
		for vehicles with tiptronic also use:	**>>8D-1-109080 078 145 719 AC	1	
(1)	078 145 805 N	charge air cooler F 8D-1-109 081>>*	left	1	
		for manual transmission also use:	**>>8D-1-109080 078 145 719 AC	1	
(2)	078 145 813 J	bracket	left	1	
2A	078 145 913	reinforcement	left	1	manual transmission
3	050 129 669	grommet	15,5/30	2	
4	058 145 824 A	grommet		4	
5	N 904 515 01	rivet	4,8X6	X	
(6)	8D0 117 335 H	air duct	left	1	
7	N 904 190 02	speed nut	M4X15X17,5	4	
8	N 905 048 02	bolt, hex. hd. (combi.)	M4X13	4	
9	078 145 745 A	pressure hose F >> 8D-1-200 000*	left upper	1	
(9)	078 145 745 J	pressure hose F 8D-1-200 001>>*	left upper	1	
10	N 024 505 4	clamp	50-70X9X0,5	X	
11	078 145 683 D	pressure pipe	left upper	1	
12	N 100 829 07	bolt, hex. hd. (combi.)	M6X16-Z1	2	
13		intake air duct see illustration:	133-75		
14	078 145 671 B	pressure hose	left upper	1	
15	N 102 581 01	clamp	23-35X9X0,5	X	
16	034 145 710 B	cut-off valve	BOSCH	2	
17	078 133 241 M	connecting hose	left upper	1	
18	078 133 609 C	charge air tube	left upper	1	

Model	Year	MG	SG	Illustration	Restrictions	UPD	15:31	19.03.2009		ETKA
A4Q	2002	1	45	145-95	>> 8D-2-010 000	713	USA			

Pos	Part Number	Name	Remarks	Qty	Model	Pos	Part Number	Name	Remarks	Qty	Model
19	N 100 053 03	bolt, hex. hd. (combi.)	M6X12-S1-N	2		33	N 101 894 03	bolt, hex. hd. (combi.)	M6X25	3	
20	078 133 603 B	charge air tube	left lower	1		34	078 145 806 L	charge air cooler	right	1	
		also use:	078 133 148	1		35	078 145 814 D	bracket	right	1	
			078 133 148 A	1		35A	078 145 914	reinforcement	right	1	
21	078 133 148 A	round seal	44X3,5	2		(36)	8D0 117 336 H	air duct	right	1	
22	078 133 148	round seal	50X3,5	2		37	078 145 746 E	pressure hose	right upper	1	
23	N 100 052 04	bolt, hex. hd. (combi.)	M8X18	6			F	>> 8D-1-200 000*			
24	078 133 576 A	retaining plate	left	1		(37)	078 145 746 N	pressure hose	right upper	1	
25		exhaust gas turbocharger	145-70				F	8D-1-200 001>>*			
		see illustration:				38	078 145 686 C	pressure pipe	right upper	1	
26	078 145 719 E	pressure hose	rear, lower	1			bracket	see illustration:	109-90		
		F	>> 8L-1-200 000*			39	078 145 672 B	pressure hose	right upper	1	
(26)	078 145 719 R	pressure hose	rear, lower	1		40	078 133 241 L	connecting hose	right upper	1	
		F	8L-1-200 001>>*			41	078 133 610 C	charge air tube	right upper	1	
27A	078 145 727 E	pressure pipe	left lower	1		42	078 133 604 C	charge air tube	right lower	1	
		F	>> 8D-1-200 000*					also use:	078 133 148	1	
(27A)	078 145 727 J	pressure pipe	left lower	1					078 133 148 A	1	
		F	8D-1-200 001>>*			43	078 133 576 D	retaining plate	right	1	
28	N 014 702 10	bolt, with hex. socket	M6X15	3		44		exhaust gas turbocharger	145-70		
		hd.						see illustration:			
28A	N 907 716 01	bolt, with hex. socket	M6X20	2		45	078 145 720 C	pressure hose	rear, lower	1	
		(combi.)					F	>> 8D-1-200 000*			
(29)	078 145 719 H	pressure hose	front, lower	1		(45)	078 145 720 P	pressure hose	rear, lower	1	
		F	>> 8D-1-200 000*				F	8D-1-200 001>>*			
(29)	078 145 719 AC	pressure hose	front, lower	1		46	078 145 728 F	pressure pipe	right lower	1	
		F	only for:				F	>> 8D-1-200 000*			
			>> 8D-1-200 000*			(46)	078 145 728 H	pressure pipe	right lower	1	
(29)	078 145 719 Q	pressure hose	front, lower	1			F	8D-1-200 001>>*			
		F	8D-1-200 001>>*			(47)	078 145 720 H	pressure hose	front, lower	1	
30	078 133 351 C	air distribution housing		1	manual transmission			F	>> 8D-1-200 000*		
(30)	078 133 351 H	air distribution housing		1	automatic	(47)	078 145 720 N	pressure hose	front, lower	1	
(30)	078 133 351 H	air distribution housing		1			F	8D-1-200 001>>*			
		for vehicle use in cold countries				48		intake hose	133-89		
31	078 129 734	spacer		3				see illustration:			
32	078 129 669	grommet		3		49	N 903 675 02	shouldered nut self locking	M6	1	

Model	Year	MG	SG	Illustration	Restrictions	UPD	15:31	19.03.2009	 Audi	ETKA
A4Q	2002	1	45	145-95	>> 8D-2-010 000	713	USA			

Pos	Part Number	Name	Remarks	Qty	Model	Pos	Part Number	Name	Remarks	Qty	Model
50	535 853 879 A	protective edging shorten to:	120MM 80MM	1							